

Inbuilt Zero Clearance B Vent Gas Flue Kit

Product Description

Part Number

Zero Clearance
Flue Kit

552327



Piccolo



New Orleans



Sofia



New York



Madrid

This kit contains: Gas Cowl, Outer Liner 900mm x 4,
Inner Flue Crimped 900mm x 4

Will fit Masport Piccolo, Sofia, Madrid, New Orleans & New York Gas Fires

Inbuilt Zero Clearance Gas Flue Kit Installation Instructions



Gas Cowl

Inner Flue
100mm dia x
900mm x 4

Outer Heat
Shield
150mm dia
x 900mm x 4

This flue kit has been manufactured in accordance with AS5601 2002. To ensure safety this flue kit must be installed as outlined in these instructions. Heater and flue clearances from combustible walls and timber framing must be in accordance with Masport specifications.

- 1 Locate the heater and zero clearance box in the proposed position and mark the point for penetration that is directly above the centre of the heater flue outlet. Check that the heater location allows the flue outer heat shield to clear all combustibles and timber framing by 25mm.
- 2 Cut a 200mm square hole where penetration is required using mark as guide. Fit non-combustible nogs in the ceiling space if required.
- 3 Measure overall flue length required. Assemble outer heat shield lengths together and secure with pop rivets or self-taping screws. Lower outer heat shield through the roof or false chimney chase and secure to top of zero clearance box.

The flue is required to be at least 500mm above the nearest point on any part of the roof. It is recommended that extending the flue above the ridgeline will help with down drafting issues. Refer to AS5601 2002 for more information.

- 4 Assemble the 100mm galvanized flue pipes together using pop rivets or self taping screws to secure. We recommend all flue joints be sealed. Lower the 100mm galvanized flue length from the roof through the flue outer heat shield and locate onto heater flue stub.
- 5 Fix an appropriate weather shield around the flue outer heat shield and seal to roof or chimney material with appropriate sealer.
- 6 Check 100mm galvanized inner flue length at top of flue outer heat shield at fit gas cowl.
- 7 Start heater and run for at least 15 minutes and check for flue spill where possible

Flue Kit Part Number: 552327

Note: It is the installer's responsibility to ensure that the installation complies with AS5601 2002 and all local body regulations.

Will fit Masport Piccolo, Sofia, Madrid, New Orleans & New York Gas Fires

Extension and Parts List

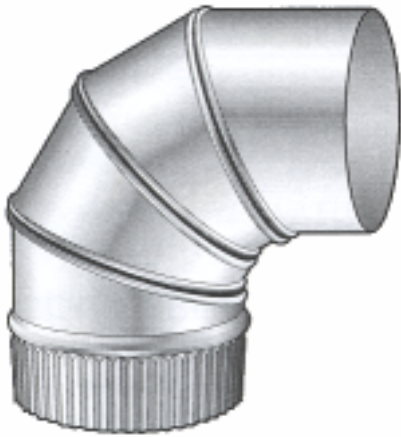

100mm Bend
Part No: 551496



B Vent Cowl
Part No: 556681



**Chimney Flashing Plate
and Cowl Kit**
Part No: 556682



100mm Galvanized Flue
Length - 900mm
Part No: 586097



**Expandable to
2 metres**

**Masonry Chimney
Extension Kit**
Part No: 946-514